

- 08\_ Floor finish
- 07\_ 65-75 mm sand & cement screed or proprietary screed
- 06\_ Warmup Nexxa Panel
- 05\_ Warmup 16 mm pipework
- 04\_ Warmup perimeter expansion strip
- 03\_ Rigid insulation (if not within subfloor)
- 02\_ DPM
- 01\_ Subfloor

REV	DATE	DESCRIPTION	DR	CH



# Warmup

The world's **best-selling** floor heating brand™

WARMUP PLC, 704 Tudor Estate, Abbey Road, London, NW10 7UW  
 Tel 0845 034 8270 Fax 0208 453 6869  
[cad@warmup.com](mailto:cad@warmup.com) [projects@warmup.com](mailto:projects@warmup.com) [www.warmup.co.uk](http://www.warmup.co.uk)

<b>DRAWING ISSUE STATUS</b>		<b>DRAWING NO</b>
<b>CONSTRUCTION</b>		01
<b>PROJECT</b>		
NEXXA SYSTEM CONCRETE SUBFLOOR		
<b>TITLE</b>		
GENERIC TEMPLATE DETAILED SECTION		
<b>PROJECT MANAGER</b>	<b>DRAWN</b>	<b>CHECKED</b>
	AA	AW
<b>DATE</b>	<b>SCALE</b>	<b>REVISION</b>
19.12.2016	1:50@A3	
<b>CAD FILE</b>		
20161212-H-NEXXA-DET SECTIONS.DWG		

**WARMUP NEXXA SYSTEM. Generic template**

© This drawing is confidential and may not be used, copied or disclosed to anyone without permission of Warmup Plc. The Copyright of these drawings remain the property of Warmup Plc.

Do not scale from drawings, all dimensions to be checked on site.

The Warmup word and associated logos are trade marks. © Warmup Plc. 2010 - Regd. TM Nos. 1257757, 4409926, 5265707. E & OE. Registered in England No. 2955213.

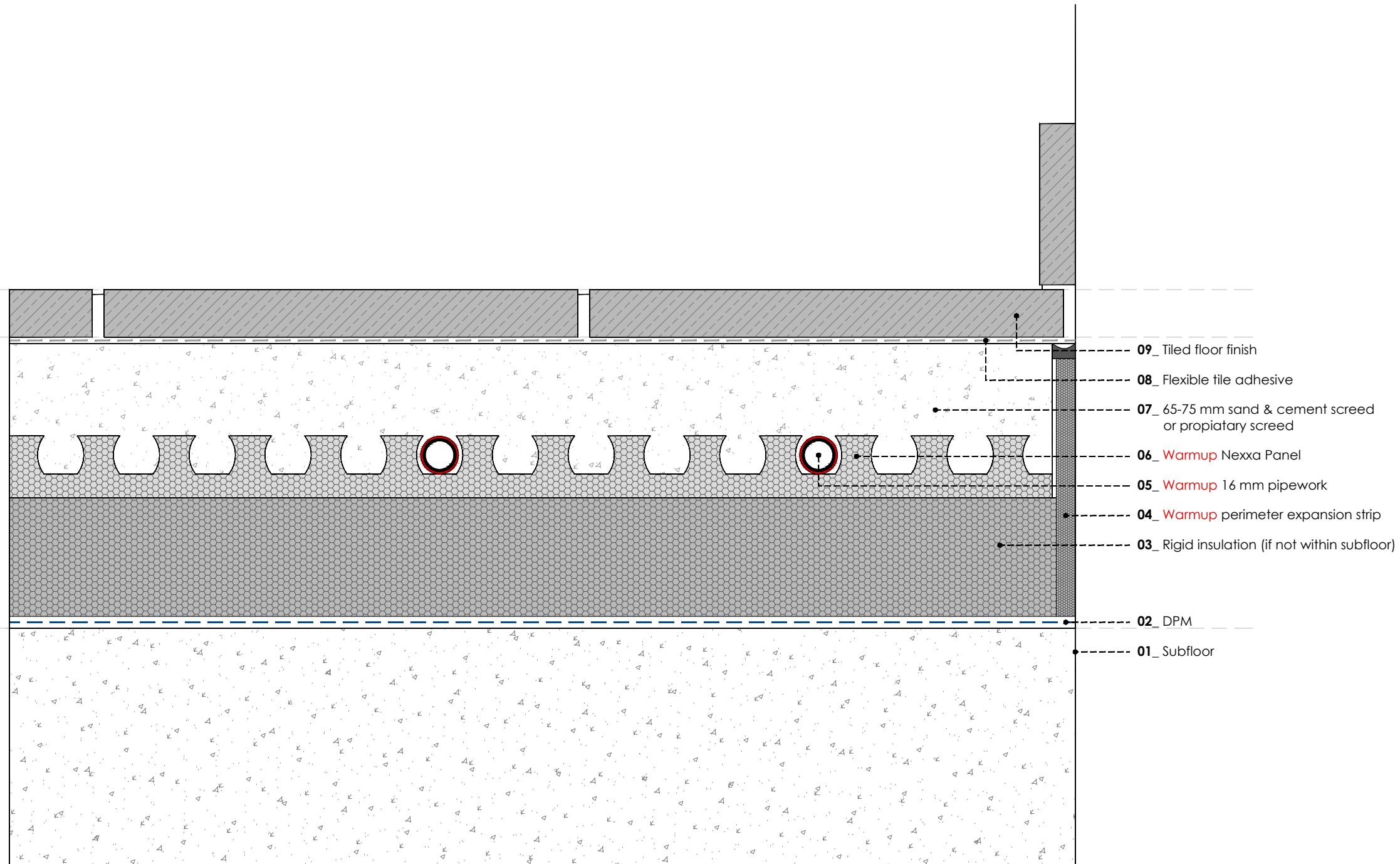

- 09\_ Tiled floor finish
- 08\_ Flexible tile adhesive
- 07\_ 65-75 mm sand & cement screed or proprietary screed
- 06\_ Warmup Nexxa Panel
- 05\_ Warmup 16 mm pipework
- 04\_ Warmup perimeter expansion strip
- 03\_ Rigid insulation (if not within subfloor)
- 02\_ DPM
- 01\_ Subfloor

REV	DATE	DESCRIPTION	DR	CH



# Warmup

The world's **best-selling** floor heating brand™

WARMUP PLC, 704 Tudor Estate, Abbey Road, London, NW10 7UW  
 Tel 0845 034 8270 Fax 0208 453 6869  
[cad@warmup.com](mailto:cad@warmup.com) [projects@warmup.com](mailto:projects@warmup.com) [www.warmup.co.uk](http://www.warmup.co.uk)

<b>DRAWING ISSUE STATUS</b>		<b>DRAWING NO</b>
<b>CONSTRUCTION</b>		02
<b>PROJECT</b>		
<b>NEXXA SYSTEM</b>		
CONCRETE SUBFLOOR		
<b>TITLE</b>		
TILED FLOOR		
<b>DETAILED SECTION</b>		
<b>PROJECT MANAGER</b>	<b>DRAWN</b>	<b>CHECKED</b>
	AA	AW
<b>DATE</b>	<b>SCALE</b>	<b>REVISION</b>
19.12.2016	1:50@A3	
<b>CAD FILE</b>		
20161212-H-NEXXA-DET SECTIONS.DWG		

**WARMUP NEXXA SYSTEM. Tiled floor**

© This drawing is confidential and may not be used, copied or disclosed to anyone without permission of Warmup Plc. The Copyright of these drawings remain the property of Warmup Plc.

Do not scale from drawings, all dimensions to be checked on site.

The Warmup word and associated logos are trade marks. © Warmup Plc. 2010 - Regd. TM Nos. 1257757, 4409926, 5265707. E & OE. Registered in England No. 2955213.

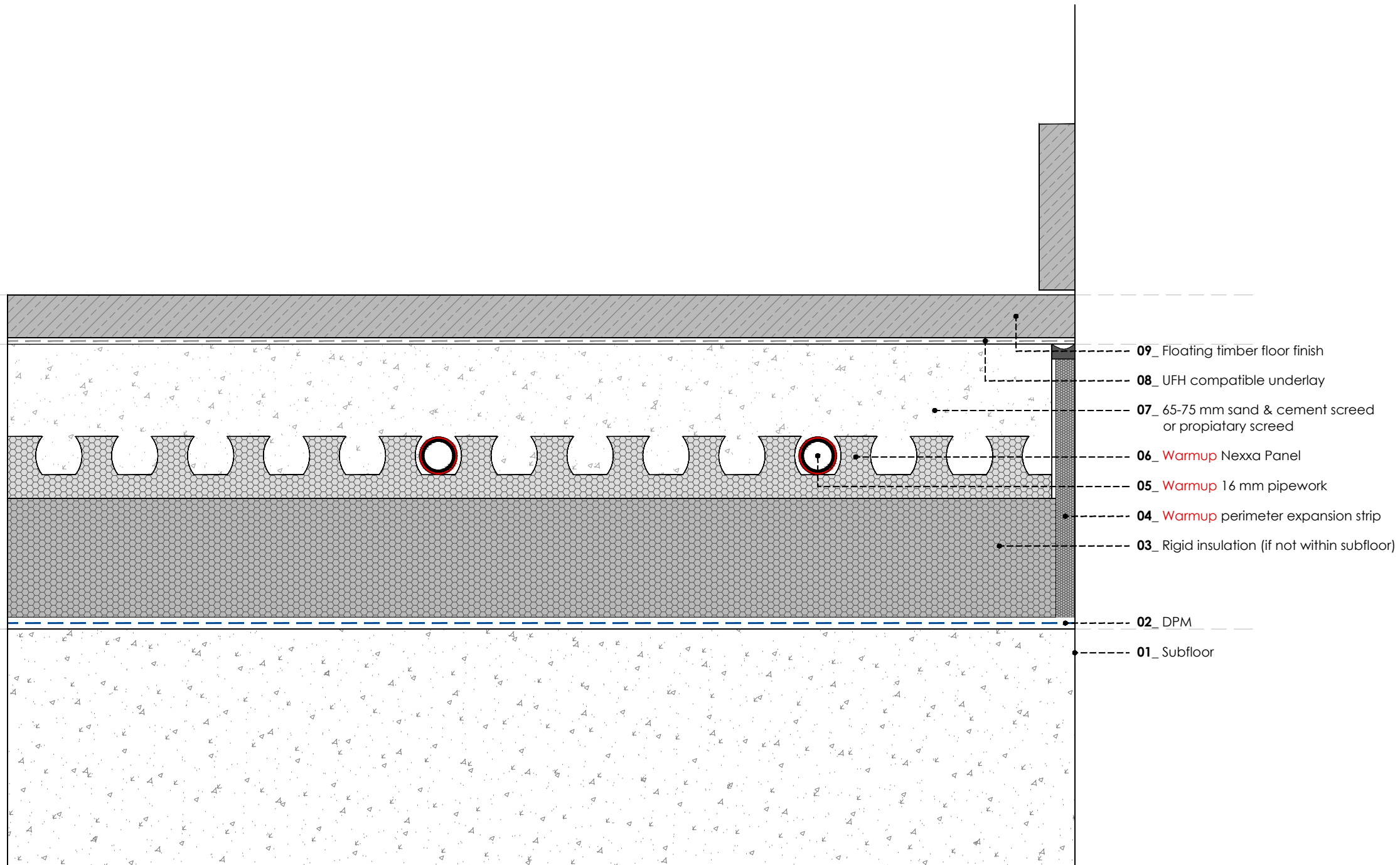

REV	DATE	DESCRIPTION	DR	CH



# Warmup

The world's **best-selling** floor heating brand™

WARMUP PLC, 704 Tudor Estate, Abbey Road, London, NW10 7UW  
 Tel 0845 034 8270 Fax 0208 453 6869  
[cad@warmup.com](mailto:cad@warmup.com) [projects@warmup.com](mailto:projects@warmup.com) [www.warmup.co.uk](http://www.warmup.co.uk)

<b>DRAWING ISSUE STATUS</b>		<b>DRAWING NO</b>
<b>CONSTRUCTION</b>		03
<b>PROJECT</b>		
<b>NEXXA SYSTEM</b>		
CONCRETE SUBFLOOR		
<b>TITLE</b>		
WOOD / LAMINATE FLOOR - FLOATING		
<b>DETAILED SECTION</b>		
<b>PROJECT MANAGER</b>	<b>DRAWN</b>	<b>CHECKED</b>
	AA	AW
<b>DATE</b>	<b>SCALE</b>	<b>REVISION</b>
19.12.2016	1:50@A3	
<b>CAD FILE</b>		
20161212-H-NEXXA-DET SECTIONS.DWG		

**WARMUP NEXXA SYSTEM. Wood / Laminate floor - floating**

© This drawing is confidential and may not be used, copied or disclosed to anyone without permission of Warmup Plc. The Copyright of these drawings remain the property of Warmup Plc.

Do not scale from drawings, all dimensions to be checked on site.

The Warmup word and associated logos are trade marks. © Warmup Plc. 2010 - Regd. TM Nos. 1257757, 4409926, 5265707. E & OE. Registered in England No. 2955213.

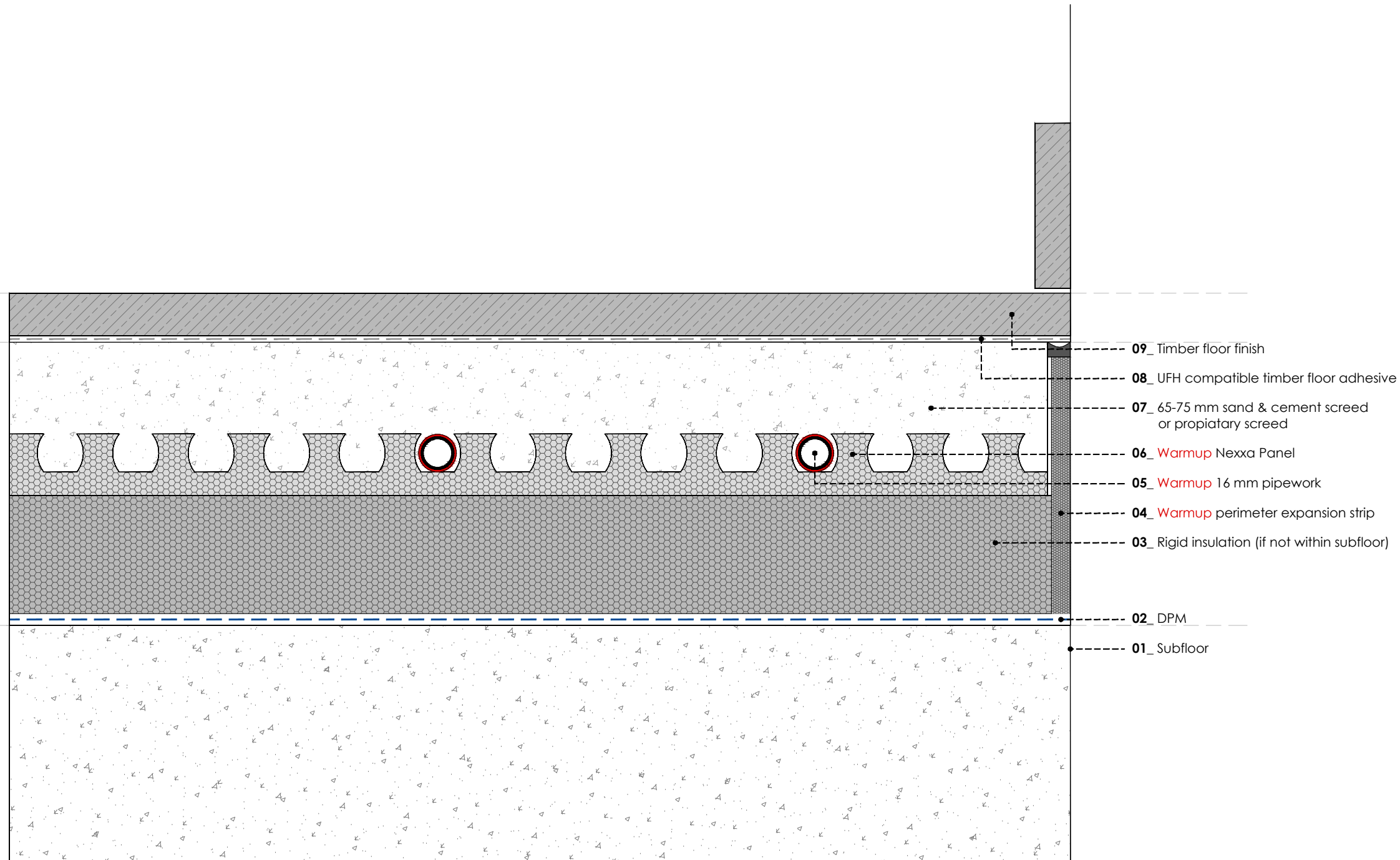

REV	DATE	DESCRIPTION	DR	CH



# Warmup

The world's best-selling floor heating brand™

WARMUP PLC, 704 Tudor Estate, Abbey Road, London, NW10 7UW  
Tel 0845 034 8270 Fax 0208 453 6869

cad@warmup.com projects@warmup.com www.warmup.co.uk

<b>DRAWING ISSUE STATUS</b>		<b>DRAWING NO</b>
<b>CONSTRUCTION</b>		04
<b>PROJECT</b>		
<b>NEXXA SYSTEM</b>		
CONCRETE SUBFLOOR		
<b>TITLE</b>		
WOOD / LAMINATE FLOOR - GLUED		
<b>DETAILED SECTION</b>		
<b>PROJECT MANAGER</b>	<b>DRAWN</b>	<b>CHECKED</b>
	AA	AW
<b>DATE</b>	<b>SCALE</b>	<b>REVISION</b>
19.12.2016	1:50@A3	
<b>CAD FILE</b>		
20161212-H-NEXXA-DET SECTIONS.DWG		

**WARMUP NEXXA SYSTEM. Wood / Laminate floor - glued**

© This drawing is confidential and may not be used, copied or disclosed to anyone without permission of Warmup Plc. The Copyright of these drawings remain the property of Warmup Plc.

Do not scale from drawings, all dimensions to be checked on site.

The Warmup word and associated logos are trade marks. © Warmup Plc. 2010 - Regd. TM Nos. 1257757, 4409926, 5265707. E & OE. Registered in England No. 2955213.

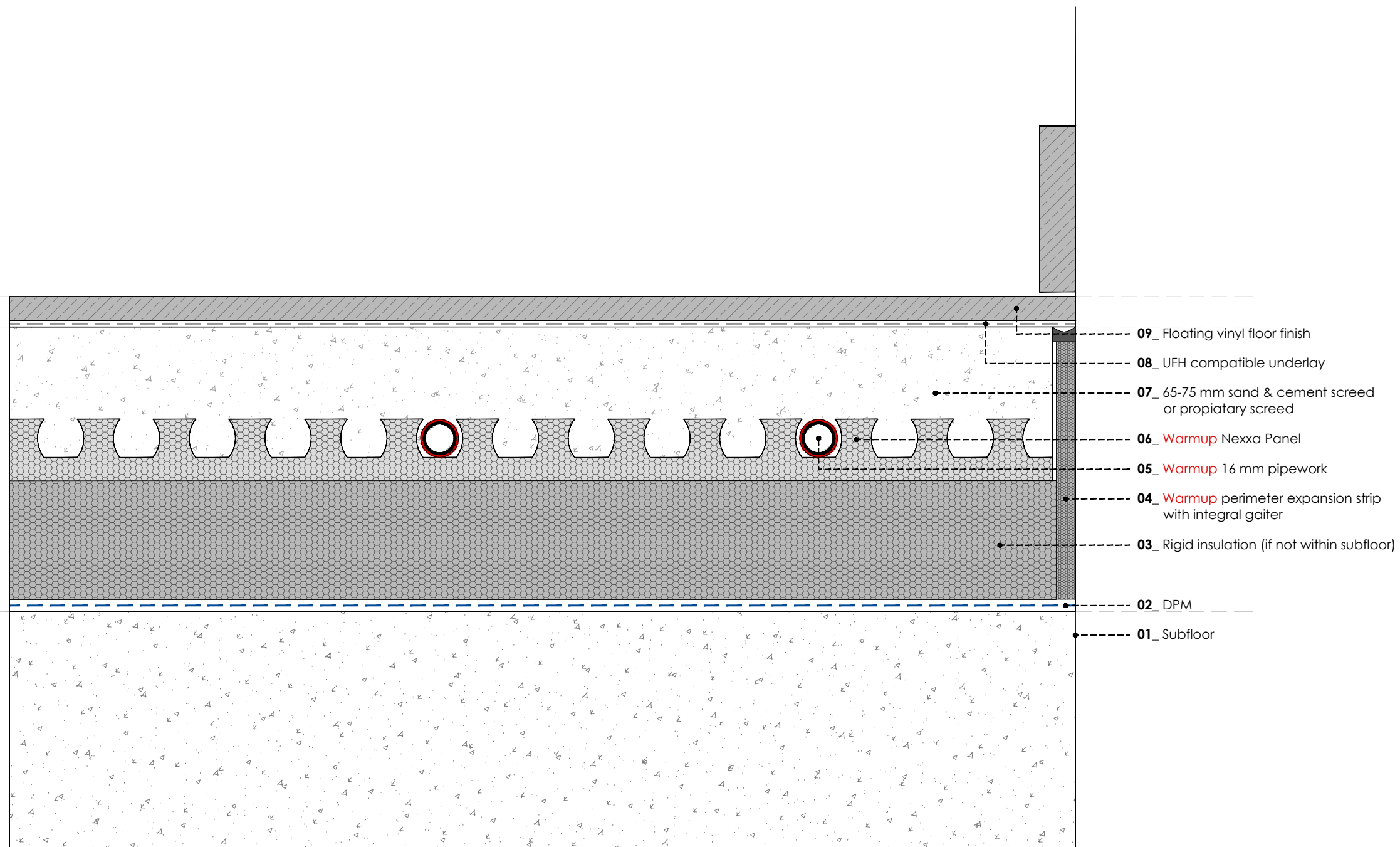

- 09\_ Floating vinyl floor finish
- 08\_ UFH compatible underlay
- 07\_ 65-75 mm sand & cement screed or proprietary screed
- 06\_ Warmup Nexxa Panel
- 05\_ Warmup 16 mm pipework
- 04\_ Warmup perimeter expansion strip with integral gaiter
- 03\_ Rigid insulation (if not within subfloor)
- 02\_ DPM
- 01\_ Subfloor

REV	DATE	DESCRIPTION	DR	CH



# Warmup

The world's **best-selling** floor heating brand™

WARMUP PLC, 704 Tudor Estate, Abbey Road, London, NW10 7UW  
Tel 0845 034 8270 Fax 0208 453 6869

cad@warmup.com projects@warmup.com www.warmup.co.uk

<b>DRAWING ISSUE STATUS</b>		<b>DRAWING NO</b>
<b>CONSTRUCTION</b>		05
<b>PROJECT</b>		
<b>NEXXA SYSTEM</b>		
CONCRETE SUBFLOOR		
<b>TITLE</b>		
VINYL FLOOR - FLOATING		
<b>DETAILED SECTION</b>		
<b>PROJECT MANAGER</b>	<b>DRAWN</b>	<b>CHECKED</b>
	AA	AW
<b>DATE</b>	<b>SCALE</b>	<b>REVISION</b>
19.12.2016	1:50@A3	
<b>CAD FILE</b>		
20161212-H-NEXXA-DET SECTIONS.DWG		

**WARMUP NEXXA SYSTEM. Vinyl floor - floating**

© This drawing is confidential and may not be used, copied or disclosed to anyone without permission of Warmup Plc. The Copyright of these drawings remain the property of Warmup Plc.

Do not scale from drawings, all dimensions to be checked on site.

The Warmup word and associated logos are trade marks. © Warmup Plc. 2010 - Regd. TM Nos. 1257757, 4409926, 5265707. E & OE. Registered in England No. 2955213.

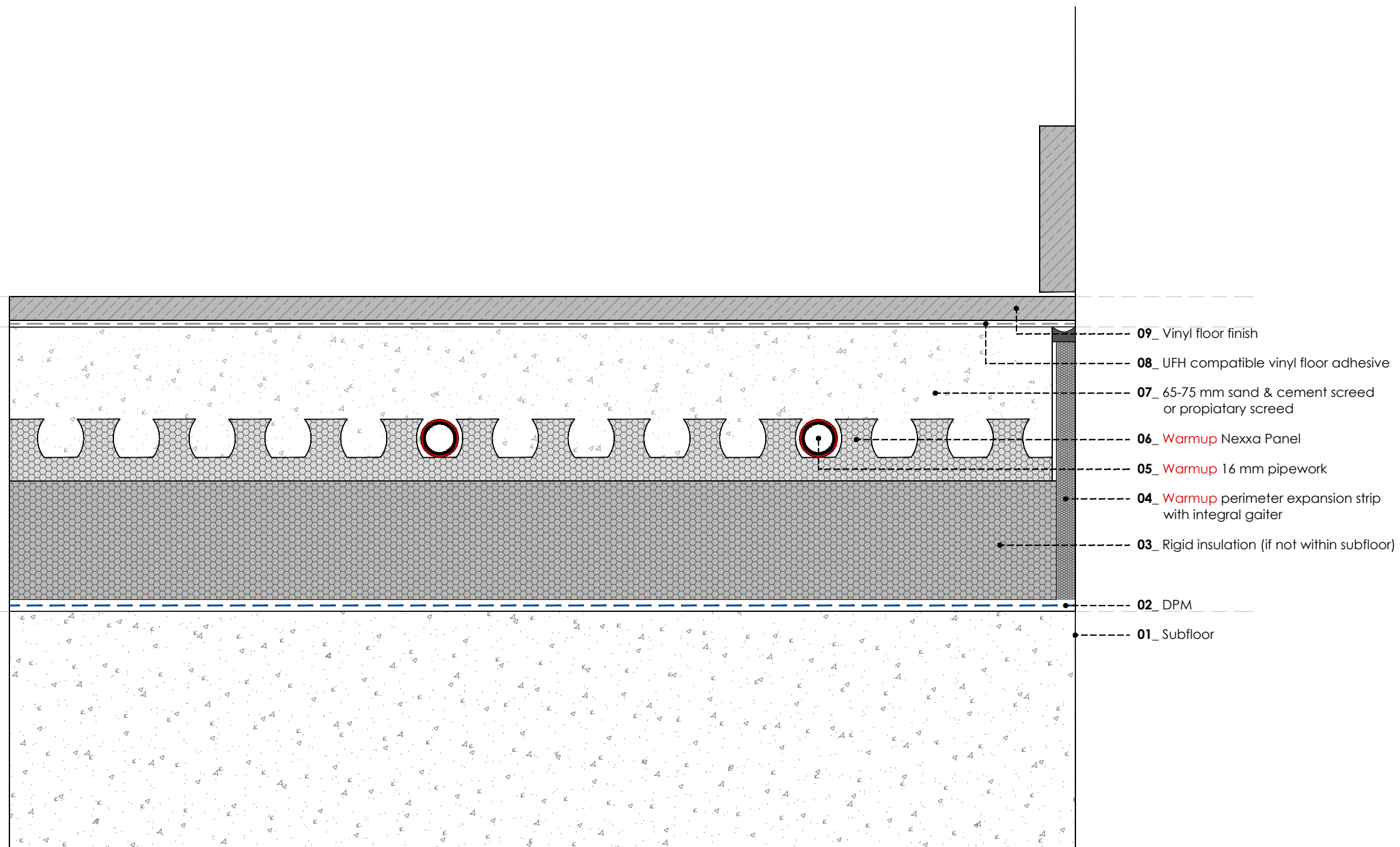

REV	DATE	DESCRIPTION	DR	CH



# Warmup

The world's **best-selling** floor heating brand™

WARMUP PLC, 704 Tudor Estate, Abbey Road, London, NW10 7UW  
 Tel 0845 034 8270 Fax 0208 453 6869  
[cad@warmup.com](mailto:cad@warmup.com) [projects@warmup.com](mailto:projects@warmup.com) [www.warmup.co.uk](http://www.warmup.co.uk)

<b>DRAWING ISSUE STATUS</b>		<b>DRAWING NO</b>
<b>CONSTRUCTION</b>		06
<b>PROJECT</b>		
<b>NEXXA SYSTEM</b>		
CONCRETE SUBFLOOR		
<b>TITLE</b>		
VINYL FLOOR - GLUED		
<b>DETAILED SECTION</b>		
<b>PROJECT MANAGER</b>	<b>DRAWN</b>	<b>CHECKED</b>
	AA	AW
<b>DATE</b>	<b>SCALE</b>	<b>REVISION</b>
19.12.2016	1:50@A3	
<b>CAD FILE</b>		
20161212-H-NEXXA-DET SECTIONS.DWG		

**WARMUP NEXXA SYSTEM. Vinyl floor - glued**

© This drawing is confidential and may not be used, copied or disclosed to anyone without permission of Warmup Plc. The Copyright of these drawings remain the property of Warmup Plc.

Do not scale from drawings, all dimensions to be checked on site.

The Warmup word and associated logos are trade marks. © Warmup Plc. 2010 - Regd. TM Nos. 1257757, 4409926, 5265707. E & OE. Registered in England No. 2955213.

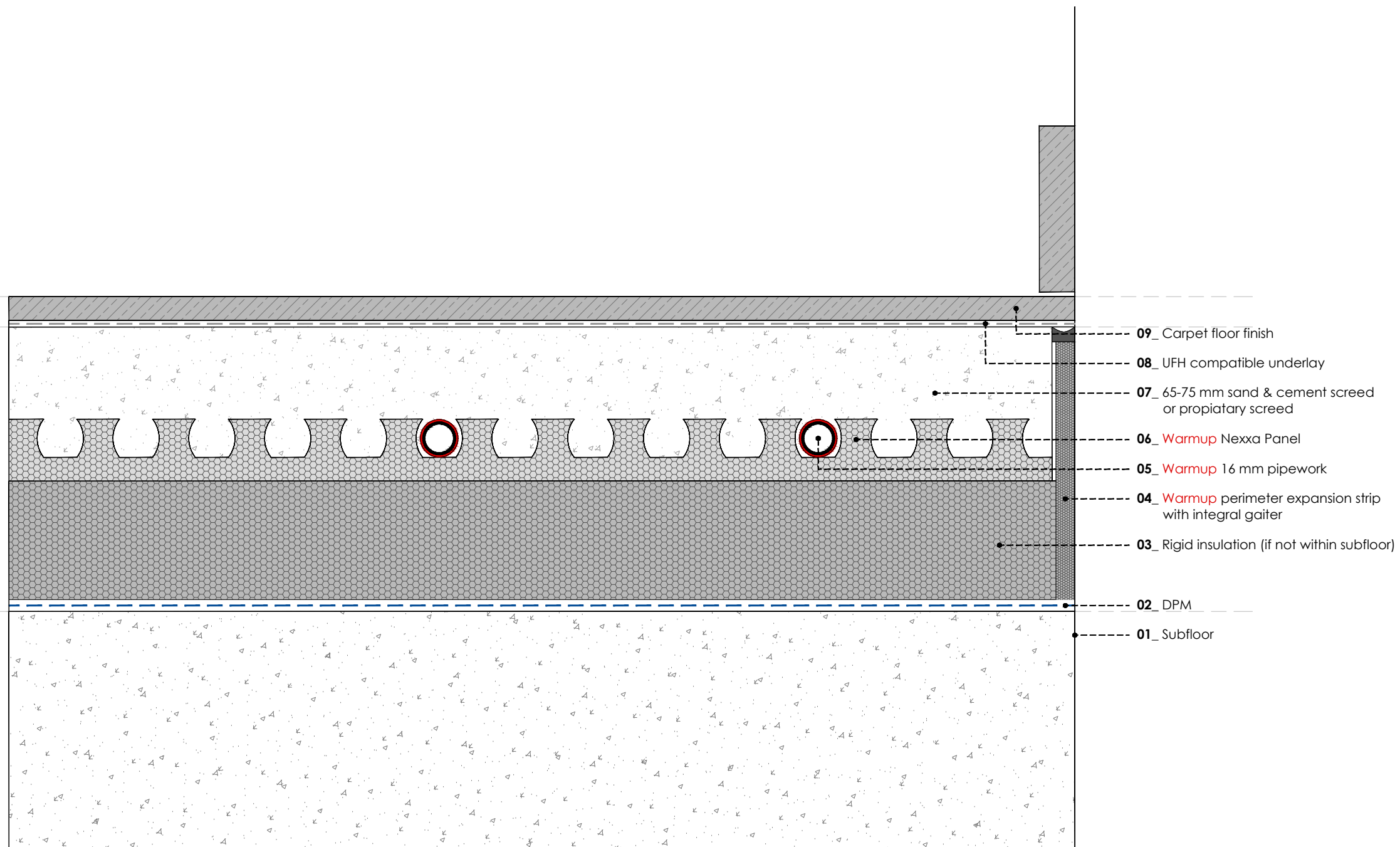

- 09\_ Carpet floor finish
- 08\_ UFH compatible underlay
- 07\_ 65-75 mm sand & cement screed or proprietary screed
- 06\_ Warmup Nexxa Panel
- 05\_ Warmup 16 mm pipework
- 04\_ Warmup perimeter expansion strip with integral gaiter
- 03\_ Rigid insulation (if not within subfloor)
- 02\_ DPM
- 01\_ Subfloor

REV	DATE	DESCRIPTION	DR	CH



# Warmup

The world's **best-selling** floor heating brand™

WARMUP PLC, 704 Tudor Estate, Abbey Road, London, NW10 7UW  
Tel 0845 034 8270 Fax 0208 453 6869  
[cad@warmup.com](mailto:cad@warmup.com) [projects@warmup.com](mailto:projects@warmup.com) [www.warmup.co.uk](http://www.warmup.co.uk)

<b>DRAWING ISSUE STATUS</b>		<b>DRAWING NO</b>
<b>CONSTRUCTION</b>		07
<b>PROJECT</b>		
<b>NEXXA SYSTEM</b>		
CONCRETE SUBFLOOR		
<b>TITLE</b>		
CARPET FLOOR		
<b>DETAILED SECTION</b>		
<b>PROJECT MANAGER</b>	<b>DRAWN</b>	<b>CHECKED</b>
	AA	AW
<b>DATE</b>	<b>SCALE</b>	<b>REVISION</b>
19.12.2016	1:50@A3	
<b>CAD FILE</b>		
20161212-H-NEXXA-DET SECTIONS.DWG		

**WARMUP NEXXA SYSTEM. Carpet floor**

© This drawing is confidential and may not be used, copied or disclosed to anyone without permission of Warmup Plc. The Copyright of these drawings remain the property of Warmup Plc.

Do not scale from drawings, all dimensions to be checked on site.

The Warmup word and associated logos are trade marks. © Warmup Plc. 2010 - Regd. TM Nos. 1257757, 4409926, 5265707. E & OE. Registered in England No. 2955213.