

- 09_ Floor finish
- 08_ 65-75 mm sand & cement screed or proprietary screed
- 07_ Warmup 40 / 60 mm Clypso Clip
- 06_ Warmup 16 mm pipework
- 05_ Warmup perimeter expansion strip with integral gaiter
- 04_ Moisture control layer
- 03_ Rigid insulation
- 02_ DPM
- 01_ Subfloor

REV	DATE	DESCRIPTION	DR	CH



Warmup

The world's **best-selling** floor heating brand™

WARMUP PLC, 704 Tudor Estate, Abbey Road, London, NW10 7UW
 Tel 0845 034 8270 Fax 0208 453 6869
cad@warmup.com projects@warmup.com www.warmup.co.uk

DRAWING ISSUE STATUS		DRAWING NO
CONSTRUCTION		01
PROJECT		
CLYPSO SYSTEM CONCRETE SUBFLOOR		
TITLE		
GENERIC TEMPLATE DETAILED SECTION		
PROJECT MANAGER	DRAWN	CHECKED
	AA	AW
DATE	SCALE	REVISION
16.12.2016	1:50@A3	

CAD FILE
 20161004-H-CLYPSO-DET SECTIONS.DWG

© This drawing is confidential and may not be used, copied or disclosed to anyone without permission of Warmup Plc. The Copyright of these drawings remain the property of Warmup Plc.

Do not scale from drawings, all dimensions to be checked on site.

The Warmup word and associated logos are trade marks. © Warmup Plc. 2010 - Regd. TM Nos. 1257757, 4409926, 5265707. E & OE. Registered in England No. 2955213.

WARMUP CLYPSO SYSTEM. Generic template

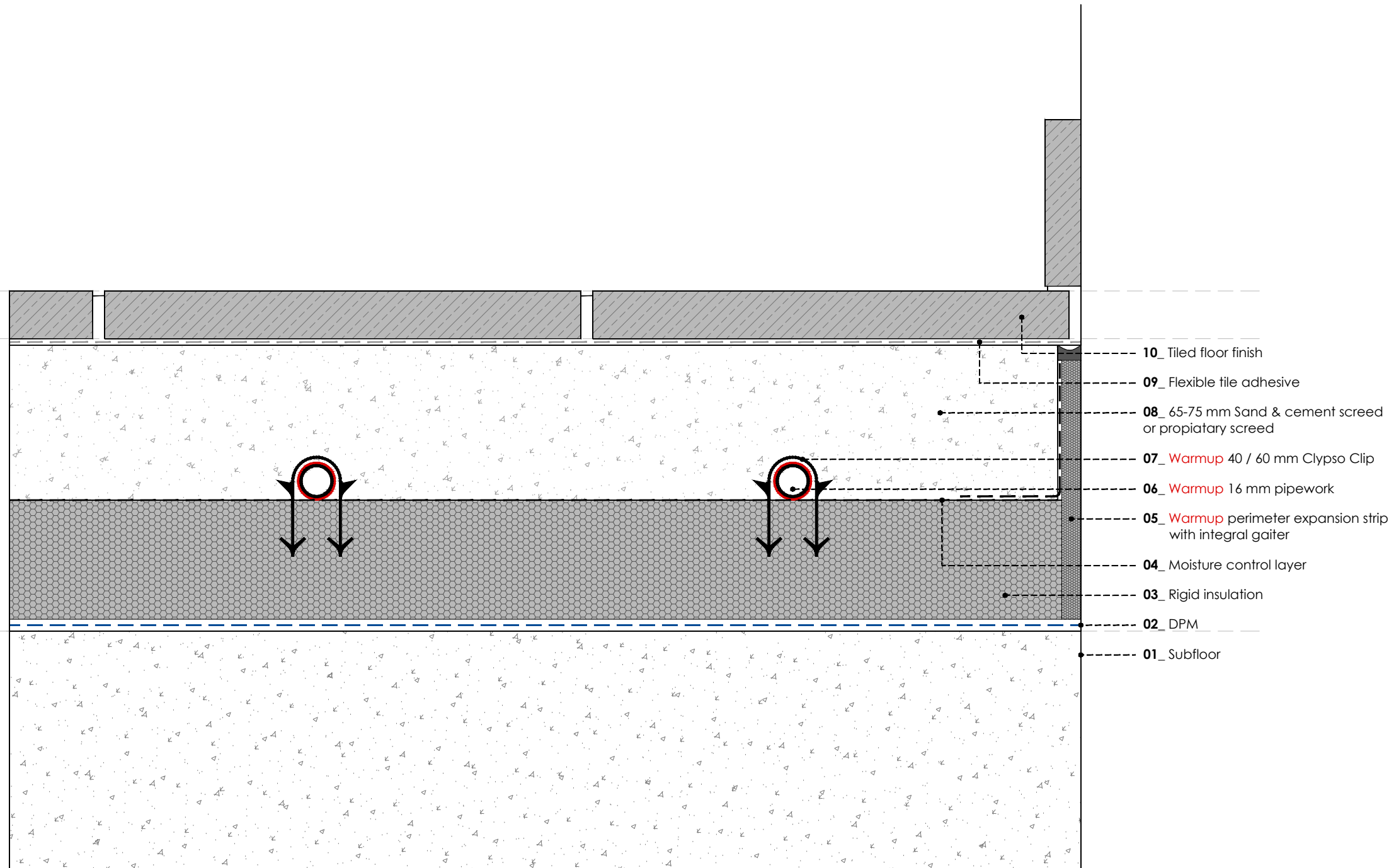

- 10_ Tiled floor finish
- 09_ Flexible tile adhesive
- 08_ 65-75 mm Sand & cement screed or proprietary screed
- 07_ Warmup 40 / 60 mm Clypso Clip
- 06_ Warmup 16 mm pipework
- 05_ Warmup perimeter expansion strip with integral gaiter
- 04_ Moisture control layer
- 03_ Rigid insulation
- 02_ DPM
- 01_ Subfloor

REV	DATE	DESCRIPTION	DR	CH



Warmup

The world's **best-selling** floor heating brand™

WARMUP PLC, 704 Tudor Estate, Abbey Road, London, NW10 7UW
 Tel 0845 034 8270 Fax 0208 453 6869
cad@warmup.com projects@warmup.com www.warmup.co.uk

DRAWING ISSUE STATUS		DRAWING NO
CONSTRUCTION		02
PROJECT		
CLYPSO SYSTEM CONCRETE SUBFLOOR		
TITLE		
TILED FLOOR DETAILED SECTION		
PROJECT MANAGER	DRAWN	CHECKED
	AA	AW
DATE	SCALE	REVISION
16.12.2016	1:50@A3	
CAD FILE		
20161004-H-CLYPSO-DET SECTIONS.DWG		

WARMUP CLYPSO SYSTEM. Tiled floor

© This drawing is confidential and may not be used, copied or disclosed to anyone without permission of Warmup Plc. The Copyright of these drawings remain the property of Warmup Plc.

Do not scale from drawings, all dimensions to be checked on site.

The Warmup word and associated logos are trade marks. © Warmup Plc. 2010 - Regd. TM Nos. 1257757, 4409926, 5265707. E & OE. Registered in England No. 2955213.

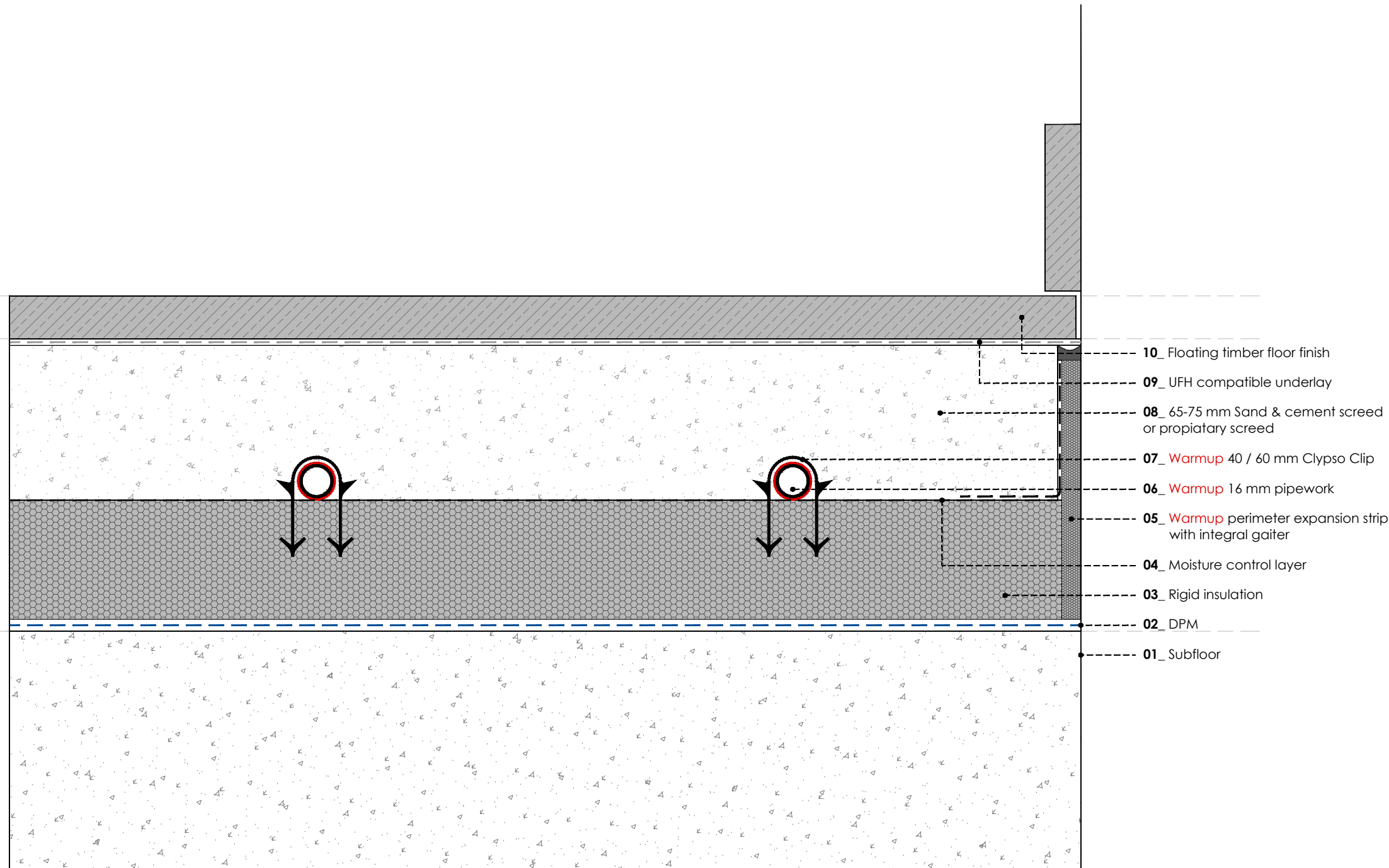

- 10_ Floating timber floor finish
- 09_ UFH compatible underlay
- 08_ 65-75 mm Sand & cement screed or proprietary screed
- 07_ Warmup 40 / 60 mm Clypso Clip
- 06_ Warmup 16 mm pipework
- 05_ Warmup perimeter expansion strip with integral gaiter
- 04_ Moisture control layer
- 03_ Rigid insulation
- 02_ DPM
- 01_ Subfloor

REV	DATE	DESCRIPTION	DR	CH



Warmup

The world's **best-selling** floor heating brand™

WARMUP PLC, 704 Tudor Estate, Abbey Road, London, NW10 7UW
Tel 0845 034 8270 Fax 0208 453 6869
cad@warmup.com projects@warmup.com www.warmup.co.uk

DRAWING ISSUE STATUS		DRAWING NO
CONSTRUCTION		03
PROJECT		
CLYPSO SYSTEM		
CONCRETE SUBFLOOR		
TITLE		
WOOD / LAMINATE FLOOR - FLOATING		
DETAILED SECTION		
PROJECT MANAGER	DRAWN	CHECKED
	AA	AW
DATE	SCALE	REVISION
16.12.2016	1:50@A3	
CAD FILE		
20161004-H-CLYPSO-DET SECTIONS.DWG		

WARMUP CLYPSO SYSTEM. Wood / laminate floor - floating

© This drawing is confidential and may not be used, copied or disclosed to anyone without permission of Warmup Plc. The Copyright of these drawings remain the property of Warmup Plc.

Do not scale from drawings, all dimensions to be checked on site.

The Warmup word and associated logos are trade marks. © Warmup Plc. 2010 - Regd. TM Nos. 1257757, 4409926, 5265707. E & OE. Registered in England No. 2955213.

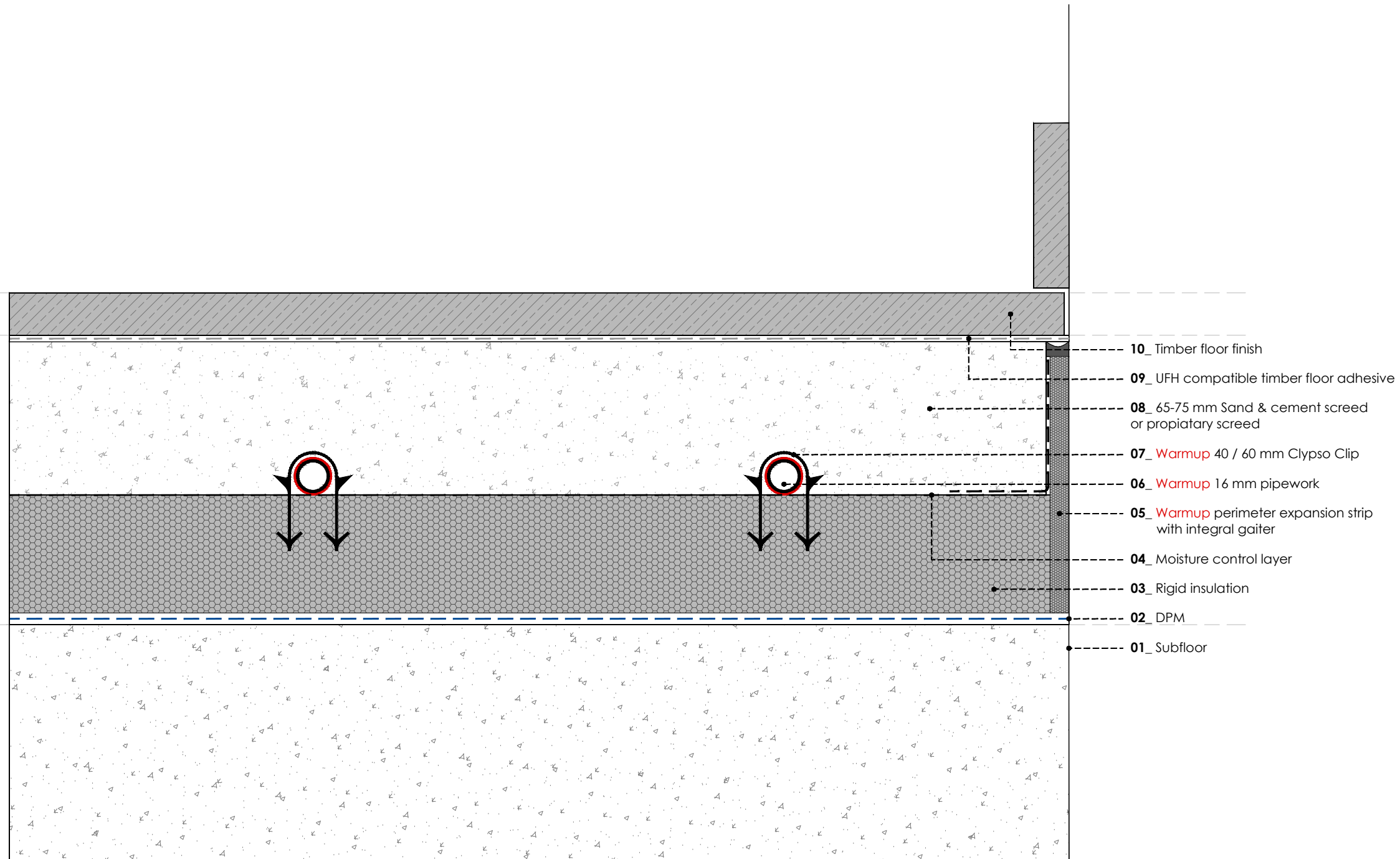

- 10_ Timber floor finish
- 09_ UFH compatible timber floor adhesive
- 08_ 65-75 mm Sand & cement screed or proprietary screed
- 07_ Warmup 40 / 60 mm Clypso Clip
- 06_ Warmup 16 mm pipework
- 05_ Warmup perimeter expansion strip with integral gaiter
- 04_ Moisture control layer
- 03_ Rigid insulation
- 02_ DPM
- 01_ Subfloor

REV	DATE	DESCRIPTION	DR	CH



Warmup

The world's **best-selling** floor heating brand™

WARMUP PLC, 704 Tudor Estate, Abbey Road, London, NW10 7UW
 Tel 0845 034 8270 Fax 0208 453 6869
cad@warmup.com projects@warmup.com www.warmup.co.uk

DRAWING ISSUE STATUS		DRAWING NO
CONSTRUCTION		04
PROJECT		
CLYPSO SYSTEM CONCRETE SUBFLOOR		
TITLE		
WOOD / LAMINATE FLOOR - GLUED DETAILED SECTION		
PROJECT MANAGER	DRAWN	CHECKED
	AA	AW
DATE	SCALE	REVISION
16.12.2016	1:50@A3	
CAD FILE		
20161004-H-CLYPSO-DET SECTIONS.DWG		

WARMUP CLYPSO SYSTEM. Wood / laminate floor - glued

© This drawing is confidential and may not be used, copied or disclosed to anyone without permission of Warmup Plc. The Copyright of these drawings remain the property of Warmup Plc.

Do not scale from drawings, all dimensions to be checked on site.

The Warmup word and associated logos are trade marks. © Warmup Plc. 2010 - Regd. TM Nos. 1257757, 4409926, 5265707. E & OE. Registered in England No. 2955213.

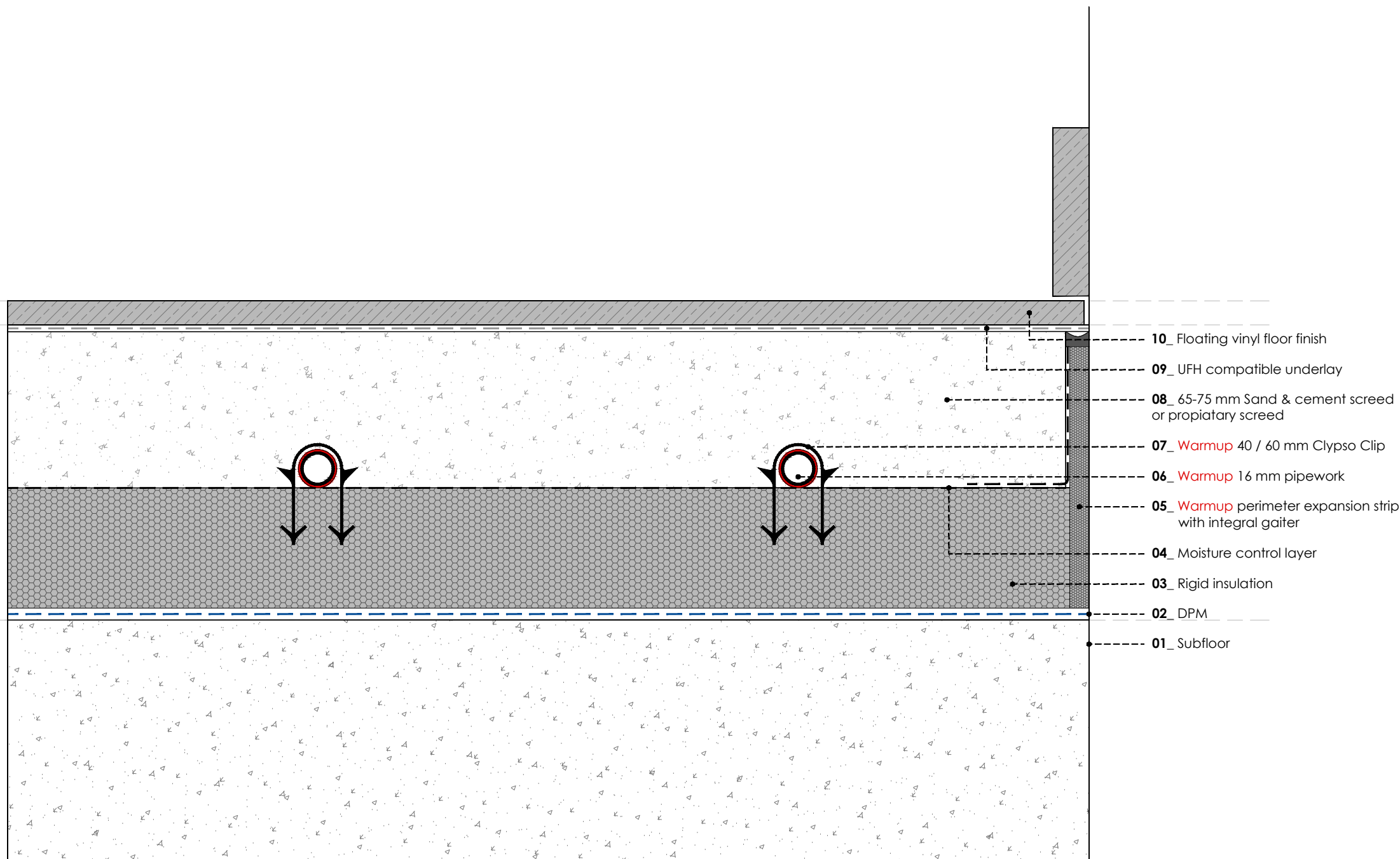

REV	DATE	DESCRIPTION	DR	CH



Warmup

The world's **best-selling** floor heating brand™

WARMUP PLC, 704 Tudor Estate, Abbey Road, London, NW10 7UW
 Tel 0845 034 8270 Fax 0208 453 6869
cad@warmup.com projects@warmup.com www.warmup.co.uk

DRAWING ISSUE STATUS		DRAWING NO
CONSTRUCTION		05
PROJECT		
CLYPSO SYSTEM CONCRETE SUBFLOOR		
TITLE		
VINYL FLOOR - FLOATING DETAILED SECTION		
PROJECT MANAGER	DRAWN	CHECKED
	AA	AW
DATE	SCALE	REVISION
16.12.2016	1:50@A3	
CAD FILE		
20161004-H-CLYPSO-DET SECTIONS.DWG		

WARMUP CLYPSO SYSTEM. Vinyl floor - floating

© This drawing is confidential and may not be used, copied or disclosed to anyone without permission of Warmup Plc. The Copyright of these drawings remain the property of Warmup Plc.

Do not scale from drawings, all dimensions to be checked on site.

The Warmup word and associated logos are trade marks. © Warmup Plc. 2010 - Regd. TM Nos. 1257757, 4409926, 5265707. E & OE. Registered in England No. 2955213.

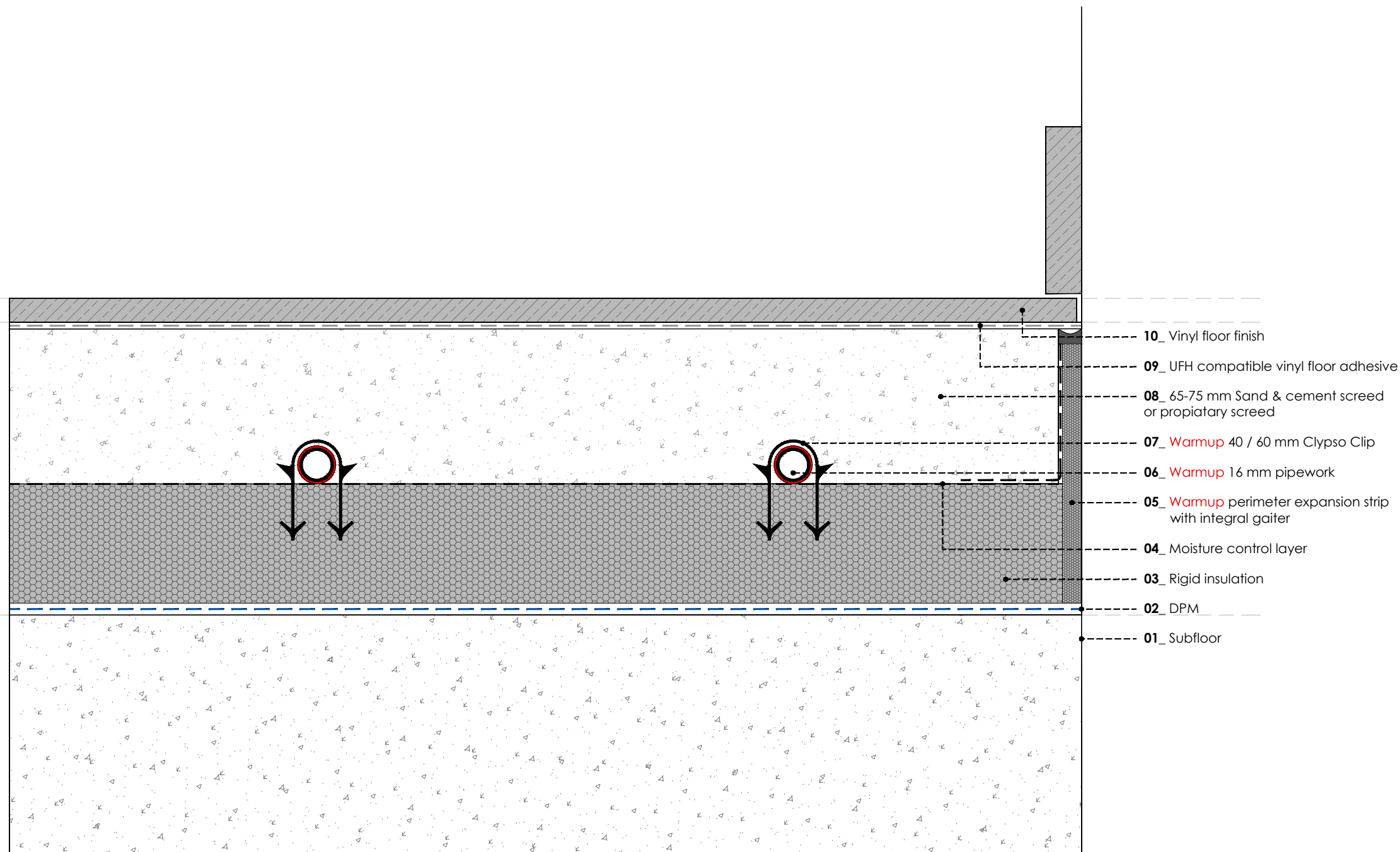

REV	DATE	DESCRIPTION	DR	CH



Warmup

The world's **best-selling** floor heating brand™

WARMUP PLC, 704 Tudor Estate, Abbey Road, London, NW10 7UW
 Tel 0845 034 8270 Fax 0208 453 6869
cad@warmup.com projects@warmup.com www.warmup.co.uk

DRAWING ISSUE STATUS		DRAWING NO
CONSTRUCTION		06
PROJECT		
CLYPSO SYSTEM CONCRETE SUBFLOOR		
TITLE		
VINYL FLOOR - GLUED DETAILED SECTION		
PROJECT MANAGER	DRAWN	CHECKED
	AA	AW
DATE	SCALE	REVISION
16.12.2016	1:50@A3	
CAD FILE		
20161004-H-CLYPSO-DET SECTIONS.DWG		

WARMUP CLYPSO SYSTEM. Vinyl floor - glued

© This drawing is confidential and may not be used, copied or disclosed to anyone without permission of Warmup Plc. The Copyright of these drawings remain the property of Warmup Plc.

Do not scale from drawings, all dimensions to be checked on site.

The Warmup word and associated logos are trade marks. © Warmup Plc. 2010 - Regd. TM Nos. 1257757, 4409926, 5265707. E & OE. Registered in England No. 2955213.

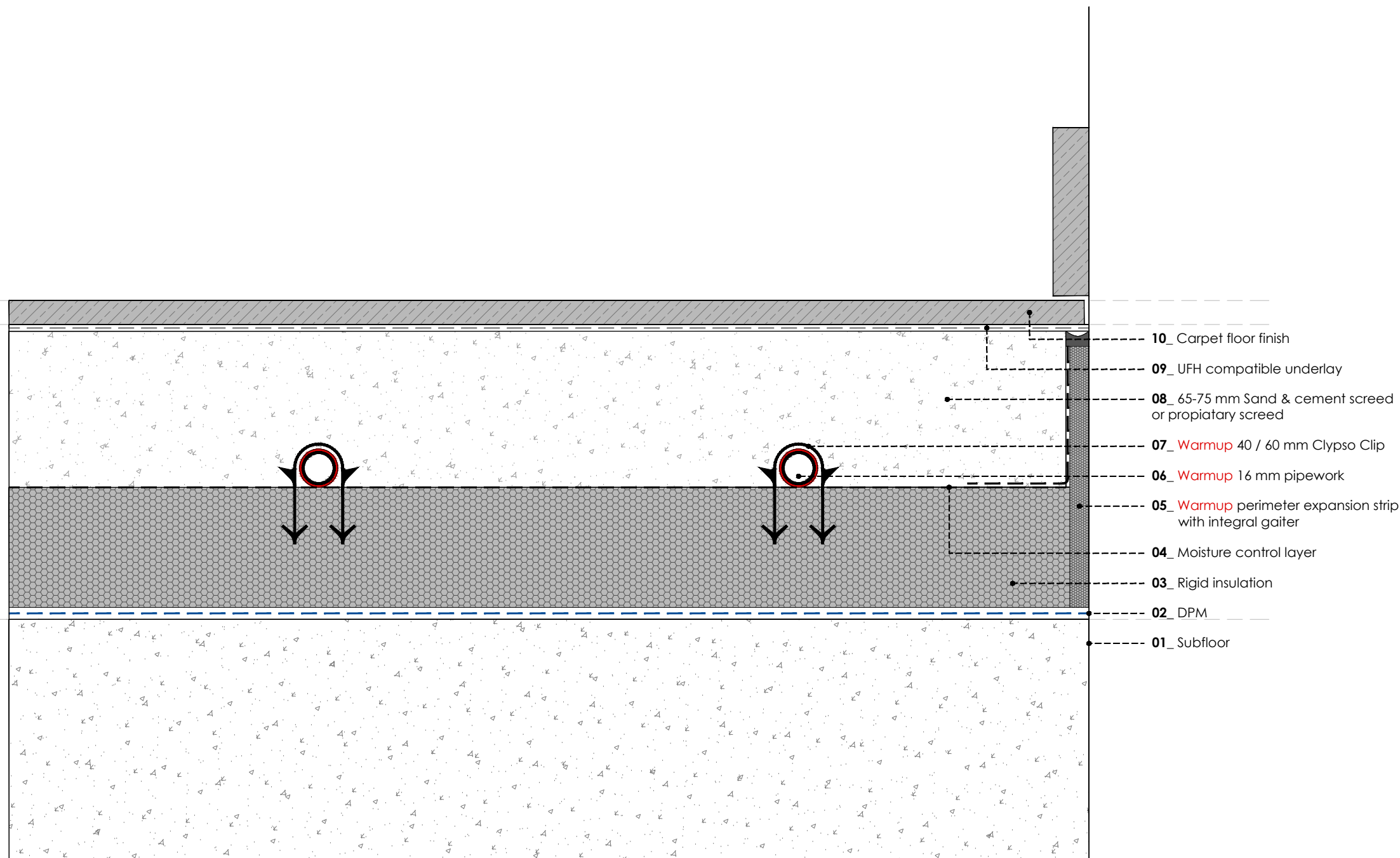

- 10_ Carpet floor finish
- 09_ UFH compatible underlay
- 08_ 65-75 mm Sand & cement screed or proprietary screed
- 07_ Warmup 40 / 60 mm Clypso Clip
- 06_ Warmup 16 mm pipework
- 05_ Warmup perimeter expansion strip with integral gaiter
- 04_ Moisture control layer
- 03_ Rigid insulation
- 02_ DPM
- 01_ Subfloor

REV	DATE	DESCRIPTION	DR	CH



Warmup

The world's **best-selling** floor heating brand™

WARMUP PLC, 704 Tudor Estate, Abbey Road, London, NW10 7UW
 Tel 0845 034 8270 Fax 0208 453 6869
cad@warmup.com projects@warmup.com www.warmup.co.uk

DRAWING ISSUE STATUS		DRAWING NO
CONSTRUCTION		07
PROJECT		
CLYPSO SYSTEM CONCRETE SUBFLOOR		
TITLE		
CARPET FLOOR DETAILED SECTION		
PROJECT MANAGER	DRAWN	CHECKED
	AA	AW
DATE	SCALE	REVISION
16.12.2016	1:50@A3	

CAD FILE
 20161004-H-CLYPSO-DET SECTIONS.DWG

© This drawing is confidential and may not be used, copied or disclosed to anyone without permission of Warmup Plc. The Copyright of these drawings remain the property of Warmup Plc.

Do not scale from drawings, all dimensions to be checked on site.

The Warmup word and associated logos are trade marks. © Warmup Plc. 2010 - Regd. TM Nos. 1257757, 4409926, 5265707. E & OE. Registered in England No. 2955213.

WARMUP CLYPSO SYSTEM. Carpet floor